

# RARSF Connector

Right Angle RAST 5 Connector

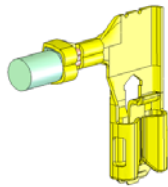
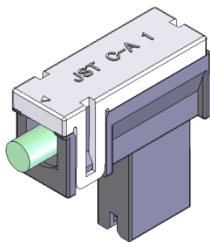
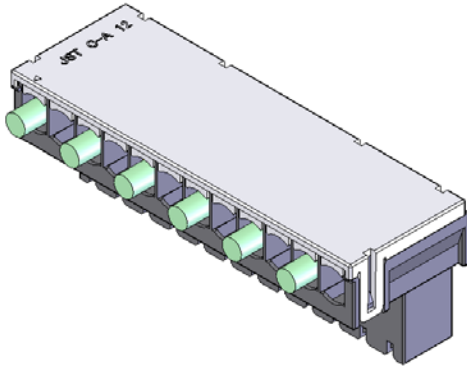

## Features

### •Right angle design

Right angle design allows ease of harness routing in tight places. Available in one circuit to twelve circuits

### •Easy insertion, positive locking

The combination of terminal and housing allows easy mating to a male tab. Un-mating is equally easy. Simply hold the housing and pull. The contact locking spring is depressed by the taper inside the housing. The locking mechanism prevents accidental disengagement of the contact from the mating tab.

### •Ultra low insertion force

The contact is designed as a low insertion force with a large contact area to give stable performance, even when high current is applied

### •Contact back out preventive design

Innovative contact and housing design eliminates contact back out caused due to damaged locking lances during termination and harness assembly.

### •Keying options

Selective removal of built-in keys and blocking housing cavities, allows for an infinite number of keying possibilities. The cover can be molded in various colors.

## Specifications

- Current rating: 15A AC, DC max. (AWG#14)  
(20A Contact under development)
- Voltage rating: 250 AC, DC max.
- Temperature range: -40°C to +105°C  
(including temperature rise in applying electrical current)
- Contact resistance: Initial value/3m Ω max.  
After environmental testing/ 6m Ω max.
- Insulation resistance: 1,000M Ω min.
- Withstanding voltage: 2,000V AC/minute
- Applicable wire: AWG# 18 to 14
- Refer to "General Instruction and Notice when using Terminals and Connectors at the end of the catalogue.
- Contact JST for details

## Standards

 Recognized E60389

**JST**

# RARSF connector

## Housing & Cover

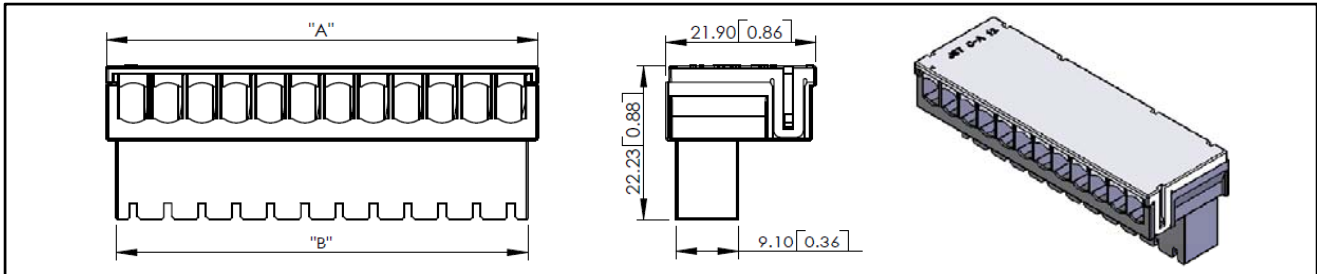

Circuit	Housing Part No.	"A" mm (in.)	"B" mm (in.)	Cover Part no.	Applicable Contact
1	RARSFP-1V-00	7.9 (0.311)	5 (0.197)	RARSFC-1V	RASRSF-61-250A RASRSF-61T-250A  Contacts under development RASRSF-21-250A RASRSF-21T-250A RASRSF-82-250A RASRSF-82T-250A RASRSF-91-250A RASRSF-91T-250A
2	RARSFP-2V-00	12.9 (0.508)	10 (0.394)	RARSFC-2V	
3	RARSFP-3V-00	17.9 (0.705)	15 (0.591)	RARSFC-3V	
4	RARSFP-4V-00	22.9 (0.902)	20 (0.787)	RARSFC-4V	
5	RARSFP-5V-00	27.9 (1.098)	25 (0.984)	RARSFC-5V	
6	RARSFP-6V-00	32.9 (1.295)	30 (1.181)	RARSFC-6V	
7	RARSFP-7V-00	37.9 (1.492)	35 (1.378)	RARSFC-7V	
8	RARSFP-8V-00	42.9 (1.689)	40 (1.575)	RARSFC-8V	
9	RARSFP-9V-00	47.9 (1.886)	45 (1.772)	RARSFC-9V	
10	RARSFP-10V-00	52.9 (2.083)	50 (1.969)	RARSFC-10V	
11	RARSFP-11V-00	57.9 (2.280)	55 (2.165)	RARSFC-11V	
12	RARSFP-12V-00	62.9 (2.476)	60 (2.362)	RARSFC-12V	

Different Keying and blocked configurations available upon request

Examples:

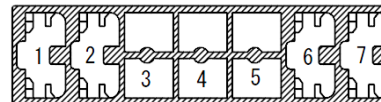
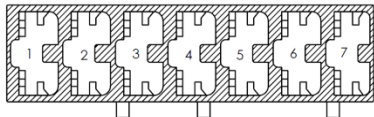
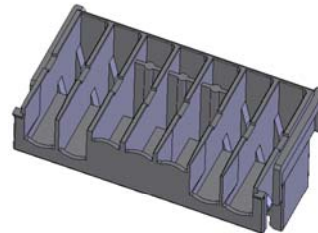
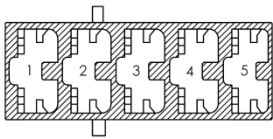

# RARSF connector

## Contacts

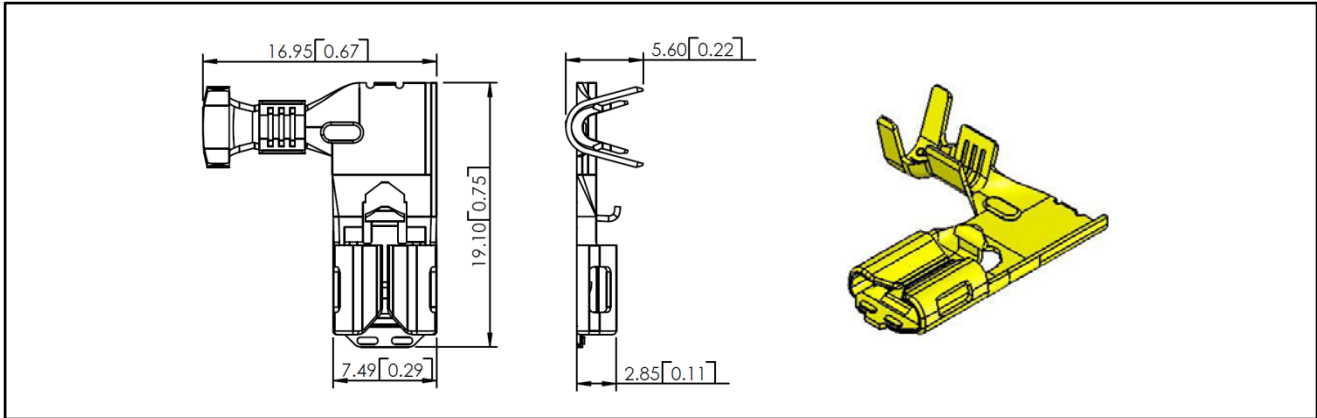

Part #	Applicable Wire			Material	Surface Finish	Qty/Reel
	mm <sup>2</sup>	AWG # UL1015	Insulation O.D. mm(in)			
RASRSF-61-250A	0.82 to 2.08	18 to 14	3.0 to 3.9 (0.118 to 0.154)	Brass	-	5,000
RASRSF-61T-250A		18+18, 18+20, 20+20			Tin Plated	

## Applicator & Die Set

Part #	JST Press		Industry Standard Press	
	Applicator	Die Set	Applicator	Die Set
RASRSF-61(-)-250A	-	-	CMKS-L	CDSRASRSF61250

## Applicable Tab

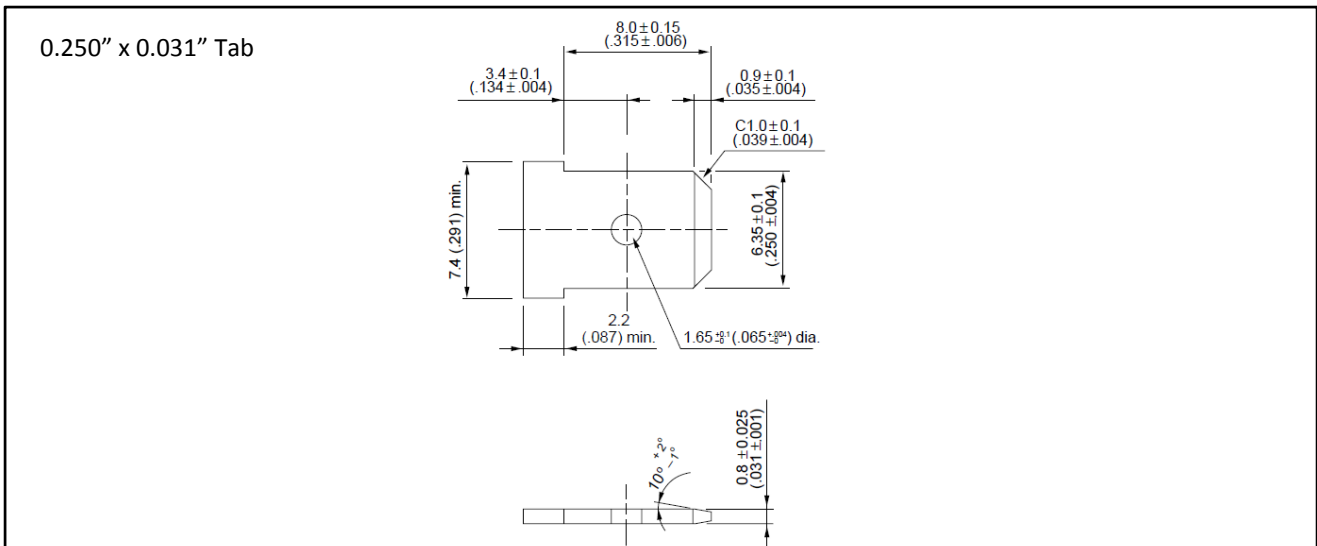

Note: Make Sure there are no unneeded ribs or other protuberances on the tab surfaces